



# KITCHEN STUDIO<sup>tm</sup>

Crafting kitchens since 2006

Arch Name: Form space &  
design

Reference : Vikas Kavar

Date: 08.07.2025



---

We are not  
just  
designing  
kitchens,  
we are  
designing  
human  
Experiences.



KITCHEN STUDIO is characterised by enduring aesthetics, functionality, craftsmanship and world class quality. We know the possibilities are endless & hence we offer the most innovative and customised solutions for all your kitchen needs.





# KITCHEN ELEVATIONAL DETAILS



KITCHENSTUDIO.IN



# TYPE A - KITCHEN LAYOUT

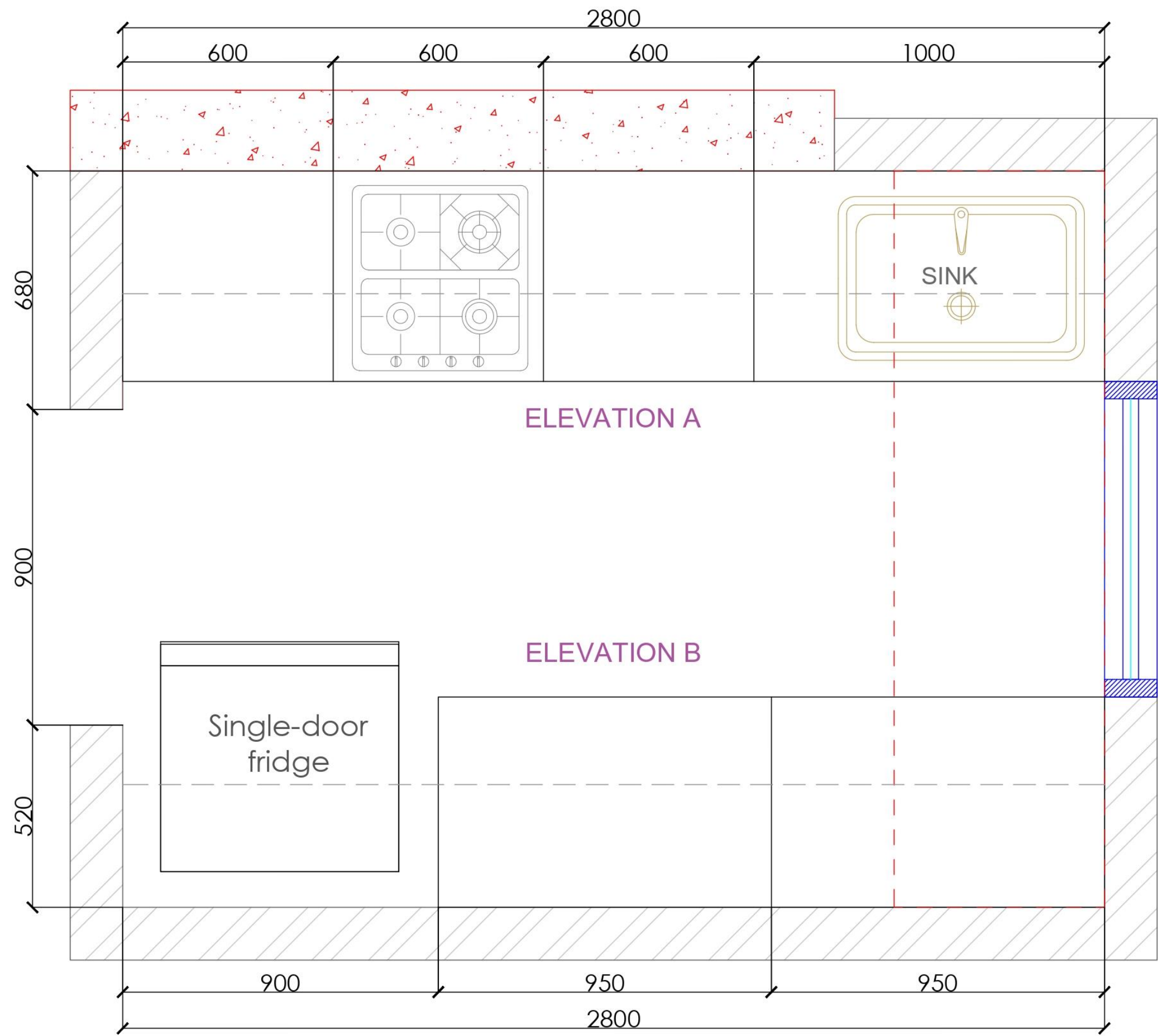

# TYPE A - OPTION 1

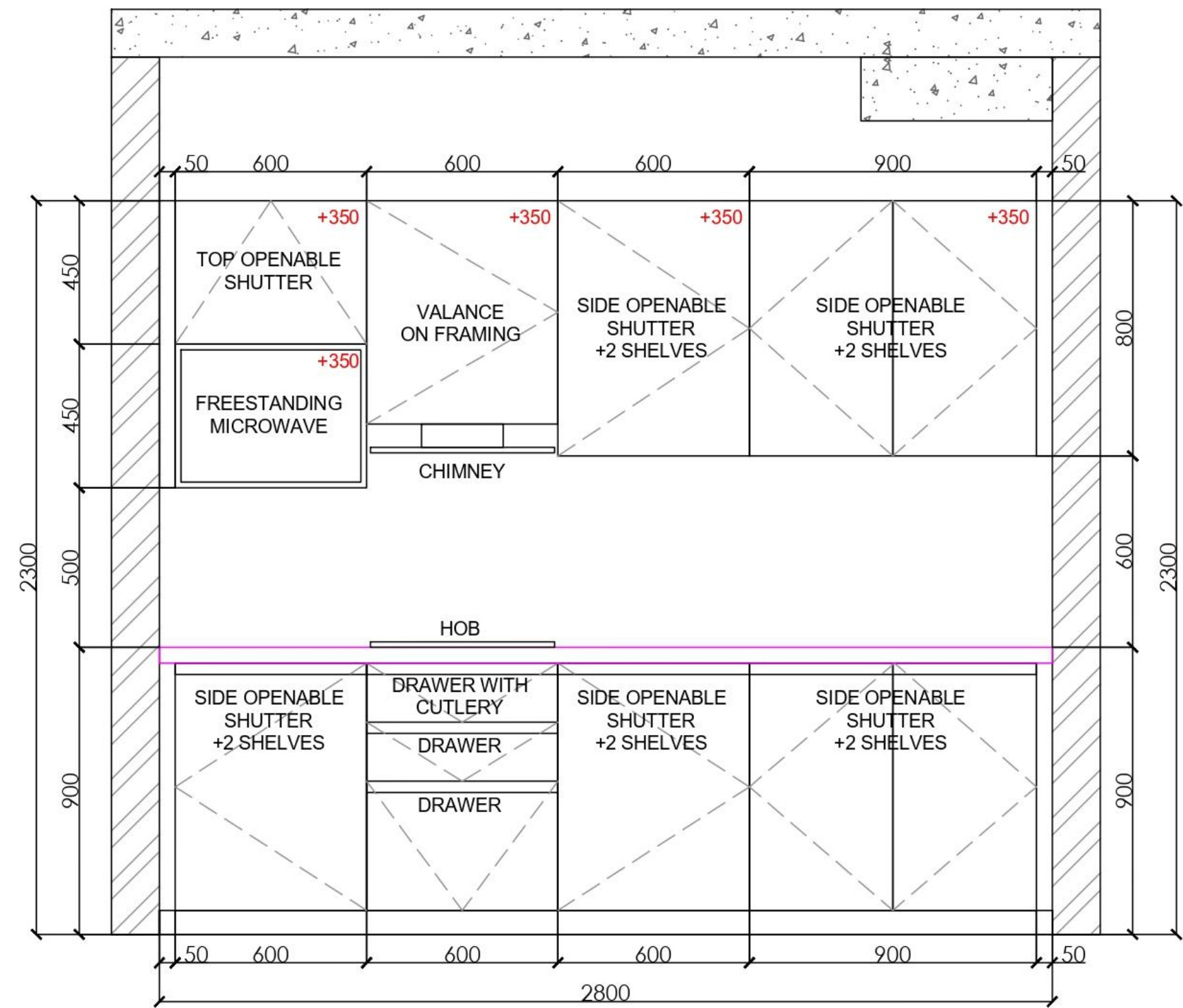

ELEVATION A

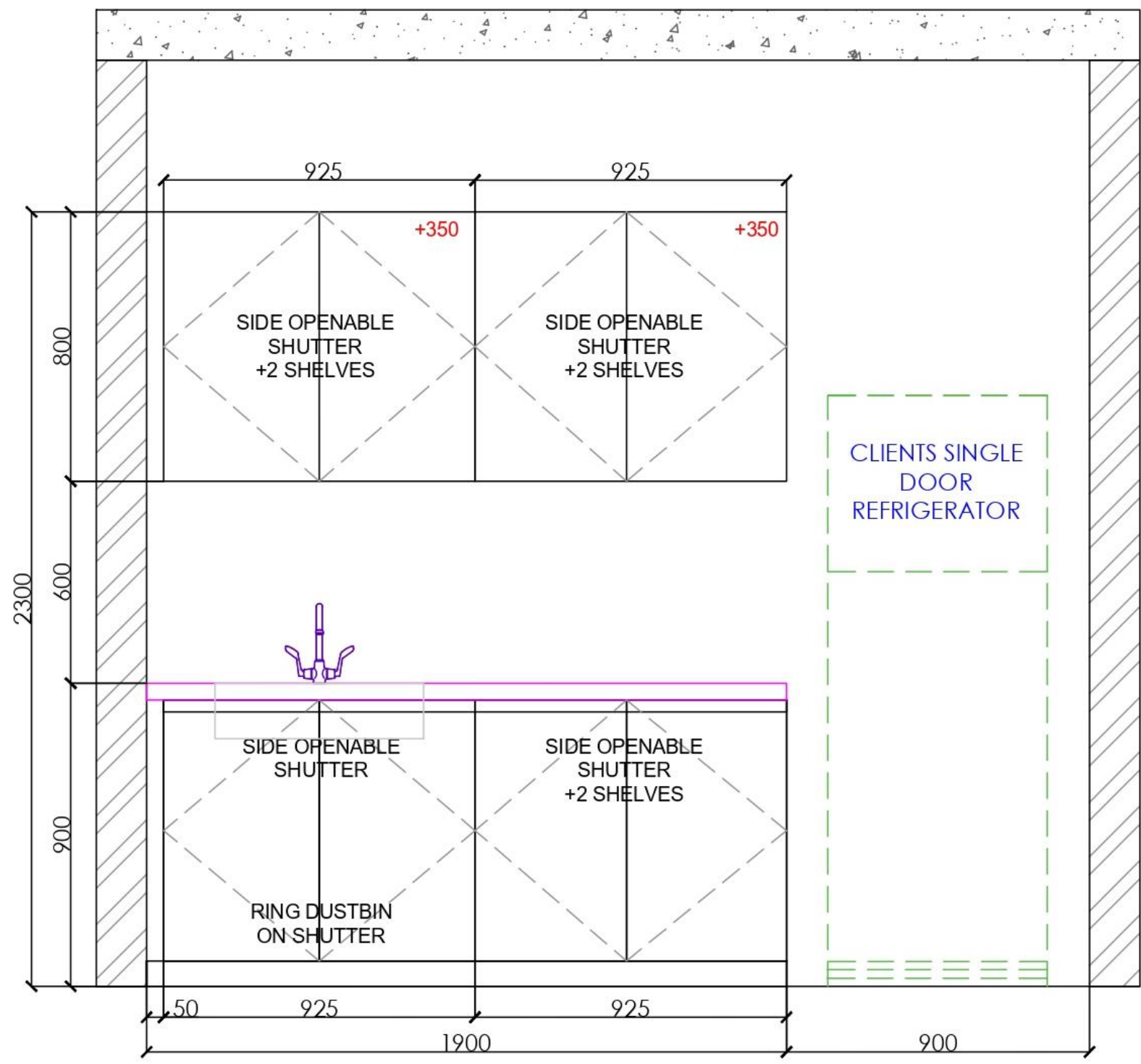

ELEVATION B





# TYPE A - OPTION 1 DETAIL



OPEN UNIT FOR MICROWAVE

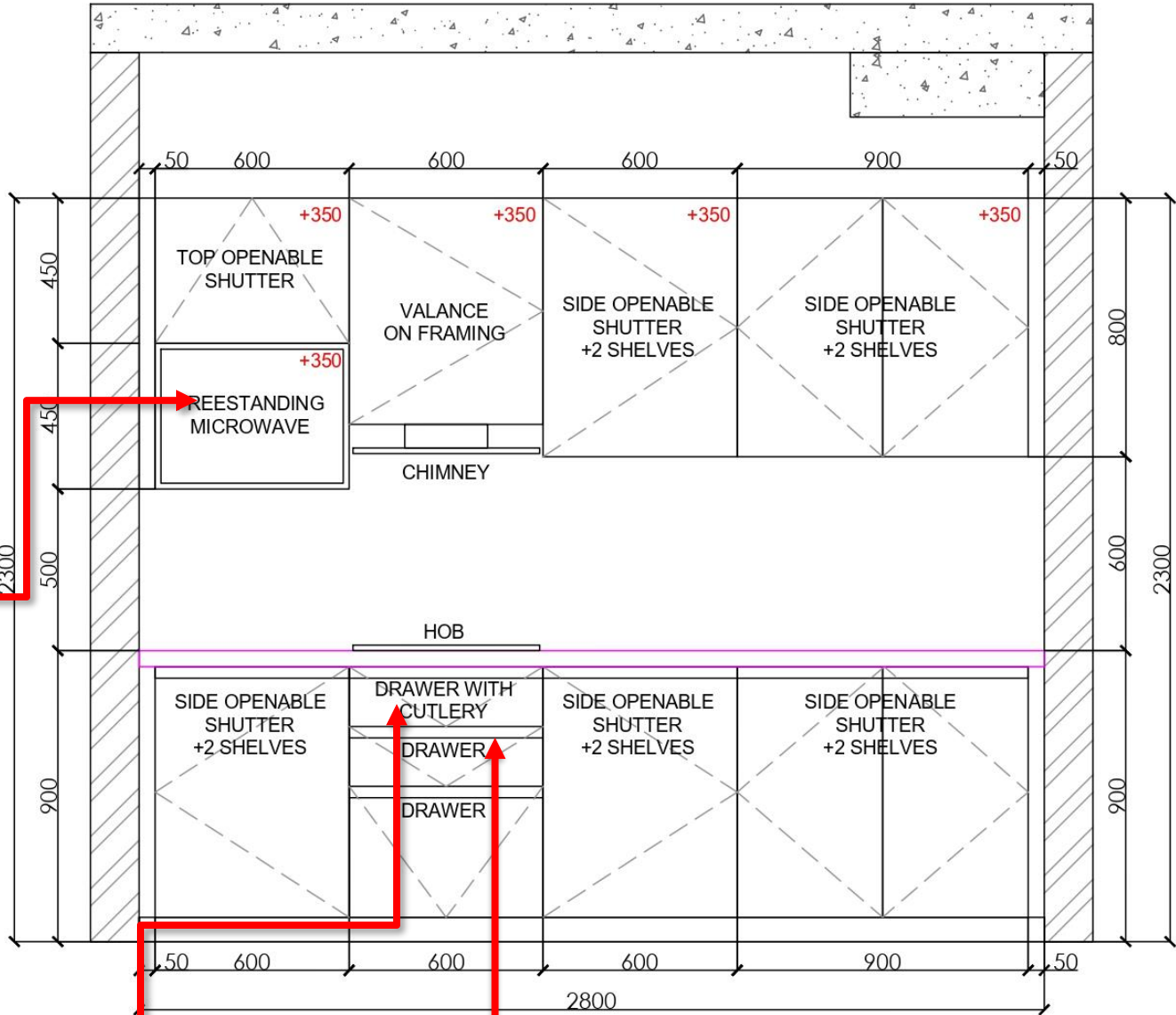

ELEVATION A



PVC CUTLERY TRAY



HETTICH-ATIRA DRAWER

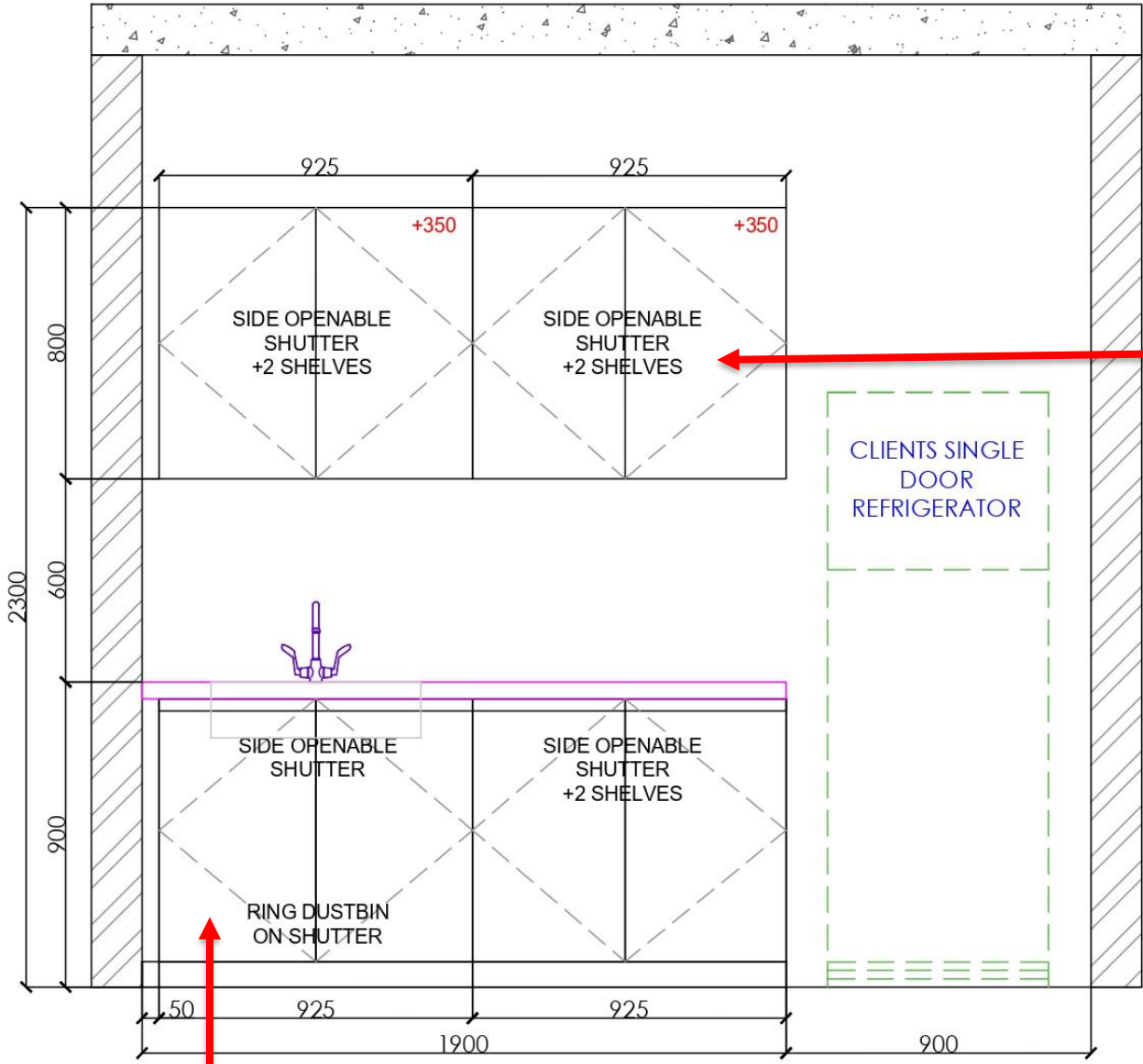

ELEVATION B



WITH 2 INTERNAL SHELF



RING DUSTBIN BELOW THE SINK

# TYPE A - OPTION 2

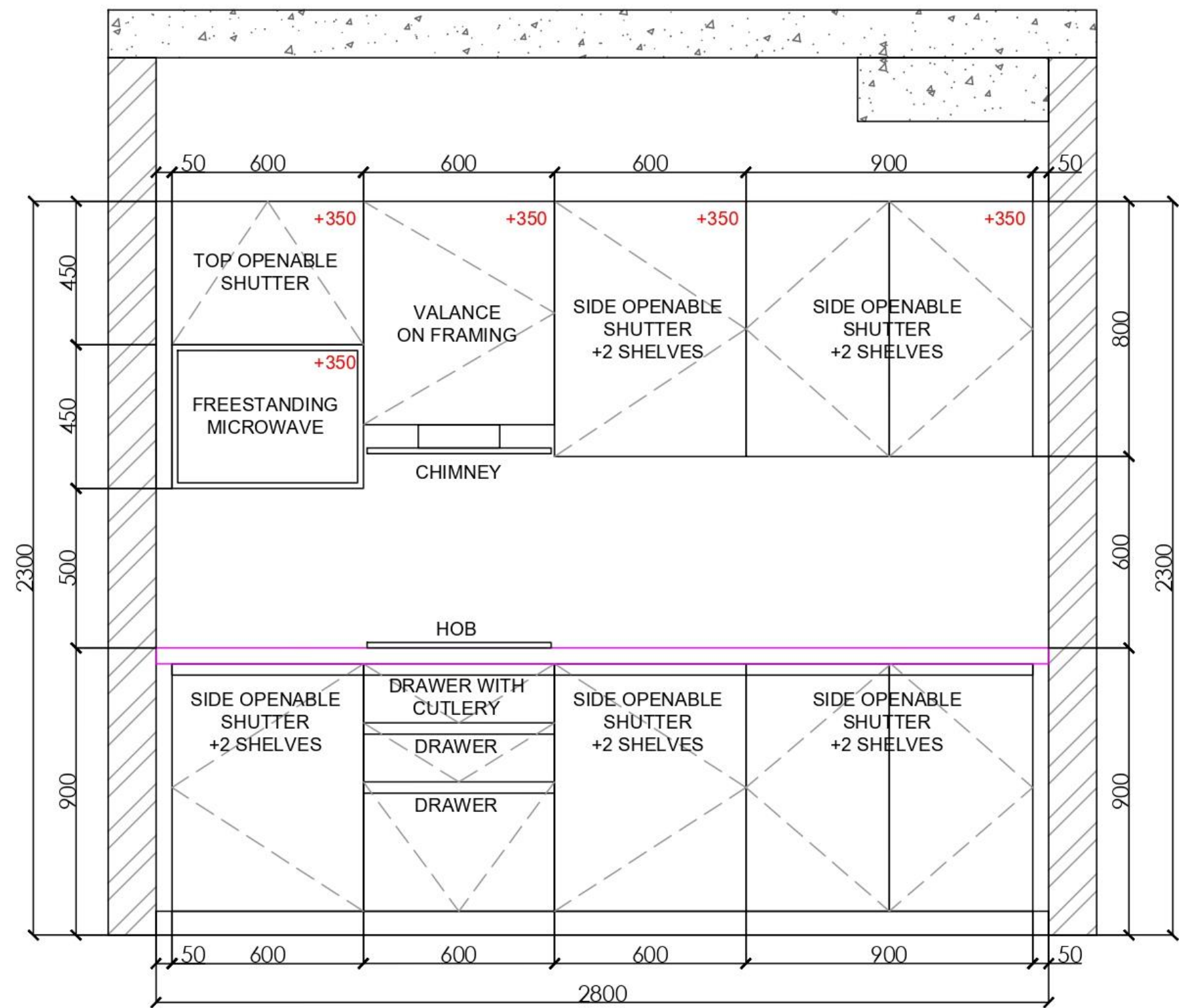

ELEVATION A

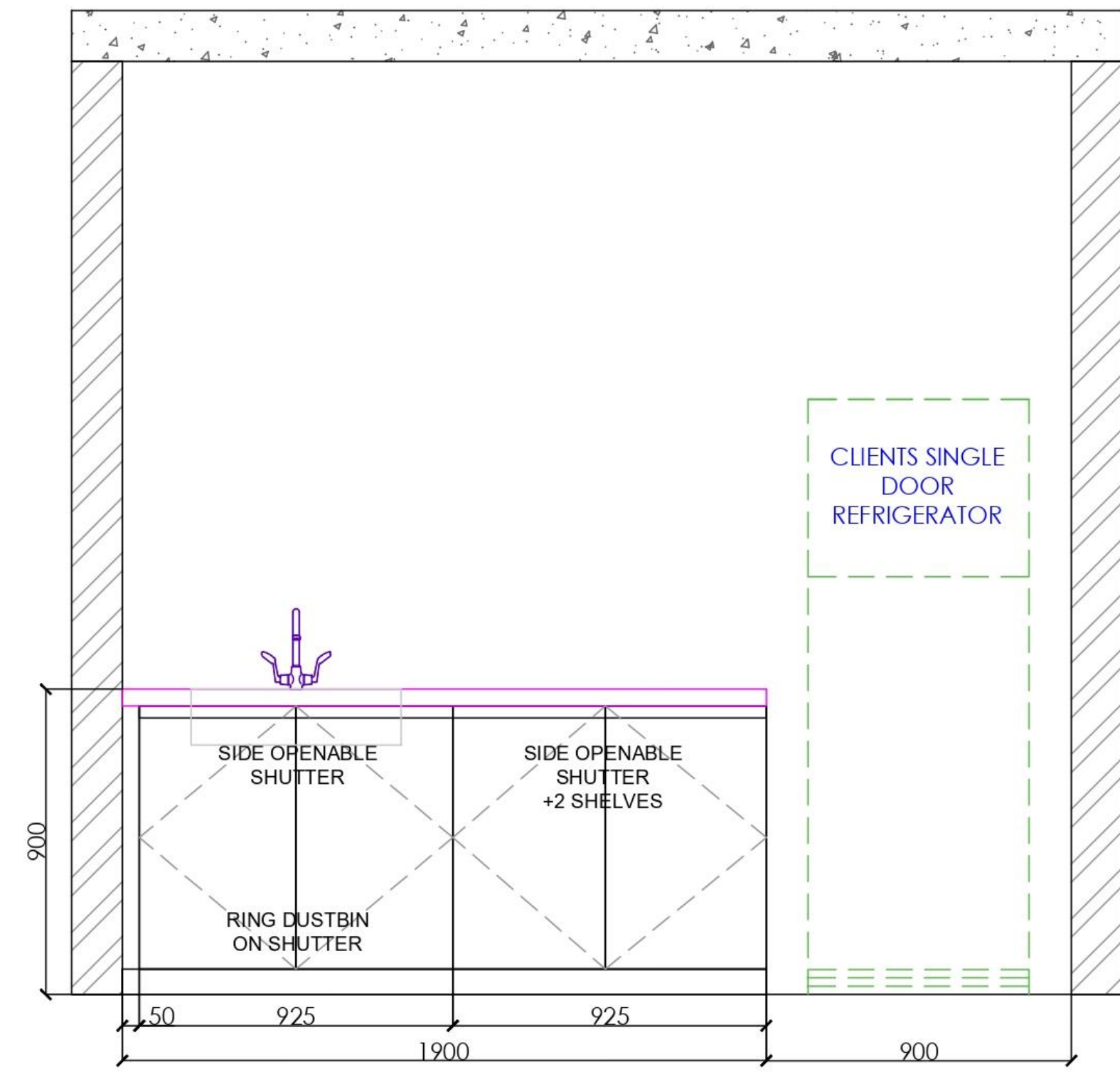

ELEVATION B

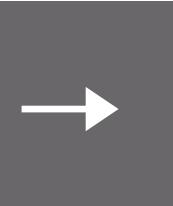



# TYPE A - OPTION 2 DETAIL



OPEN UNIT FOR  
MICROWAVE

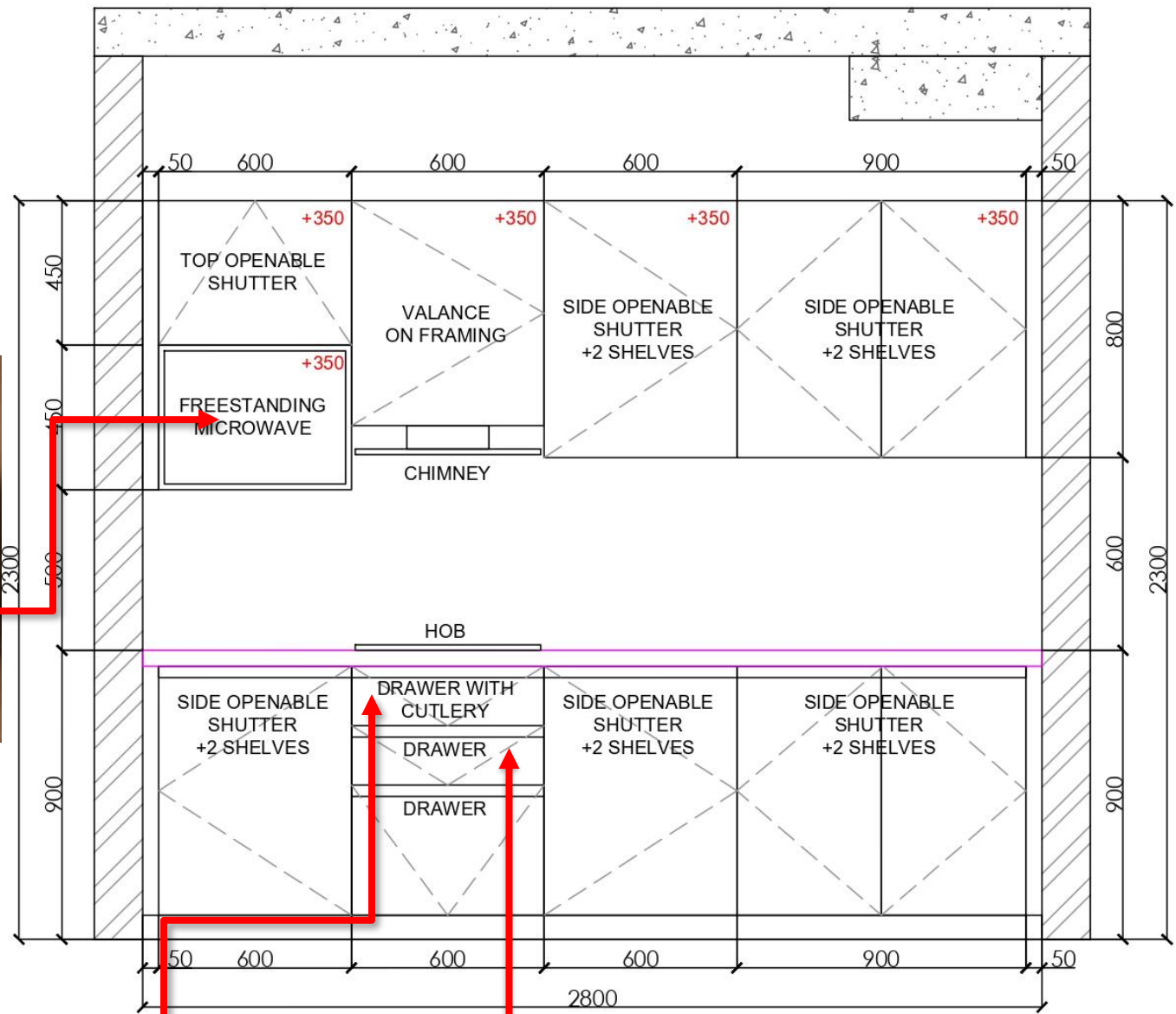

ELEVATION A



PVC CUTLERY TRAY



HETTICH-ATIRA DRAWER

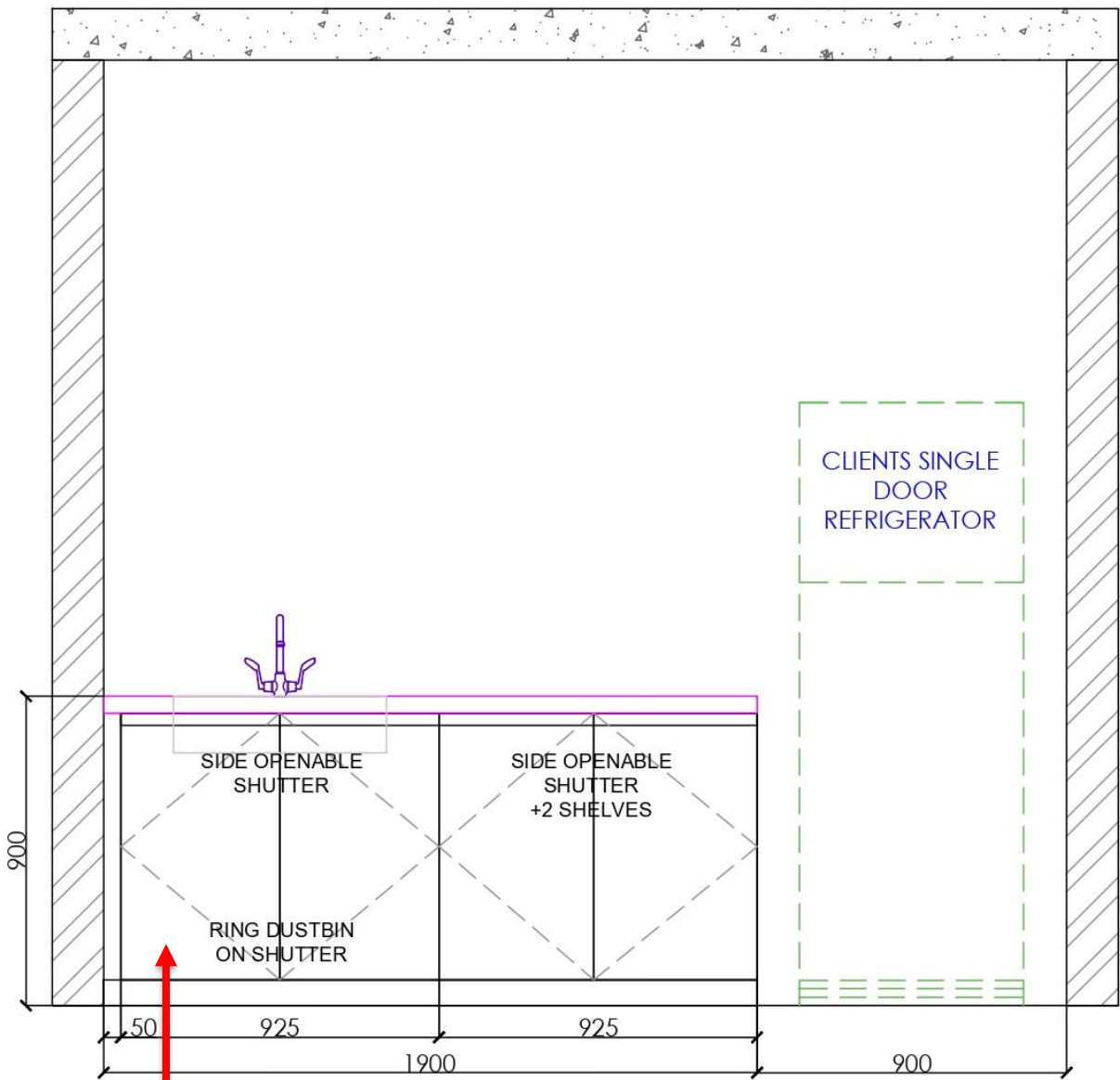

ELEVATION B



RING DUSTBIN BELOW  
THE SINK



# TYPE A - OPTION 3

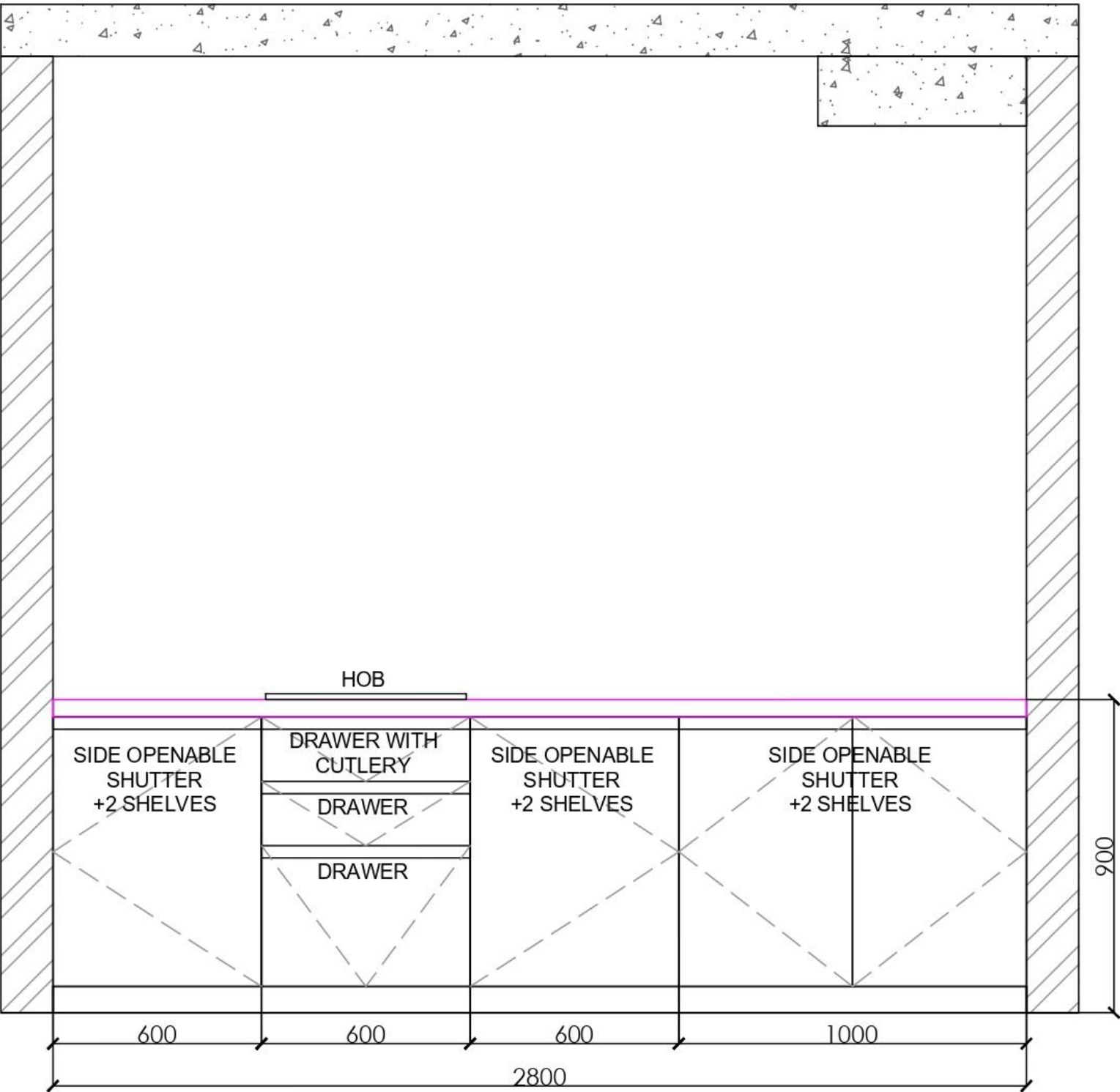

ELEVATION A

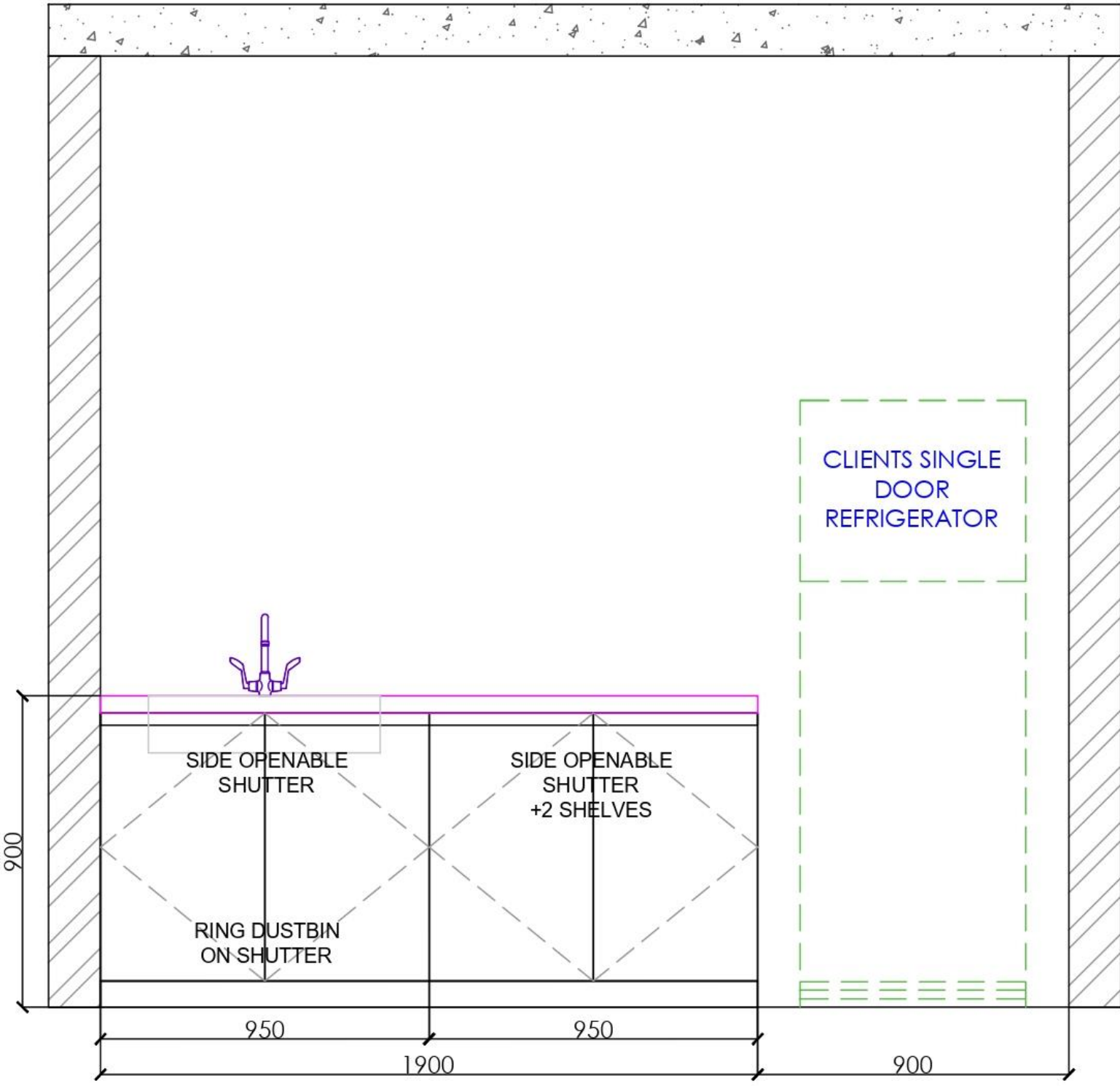

ELEVATION B



# TYPE A - OPTION 3 DETAIL

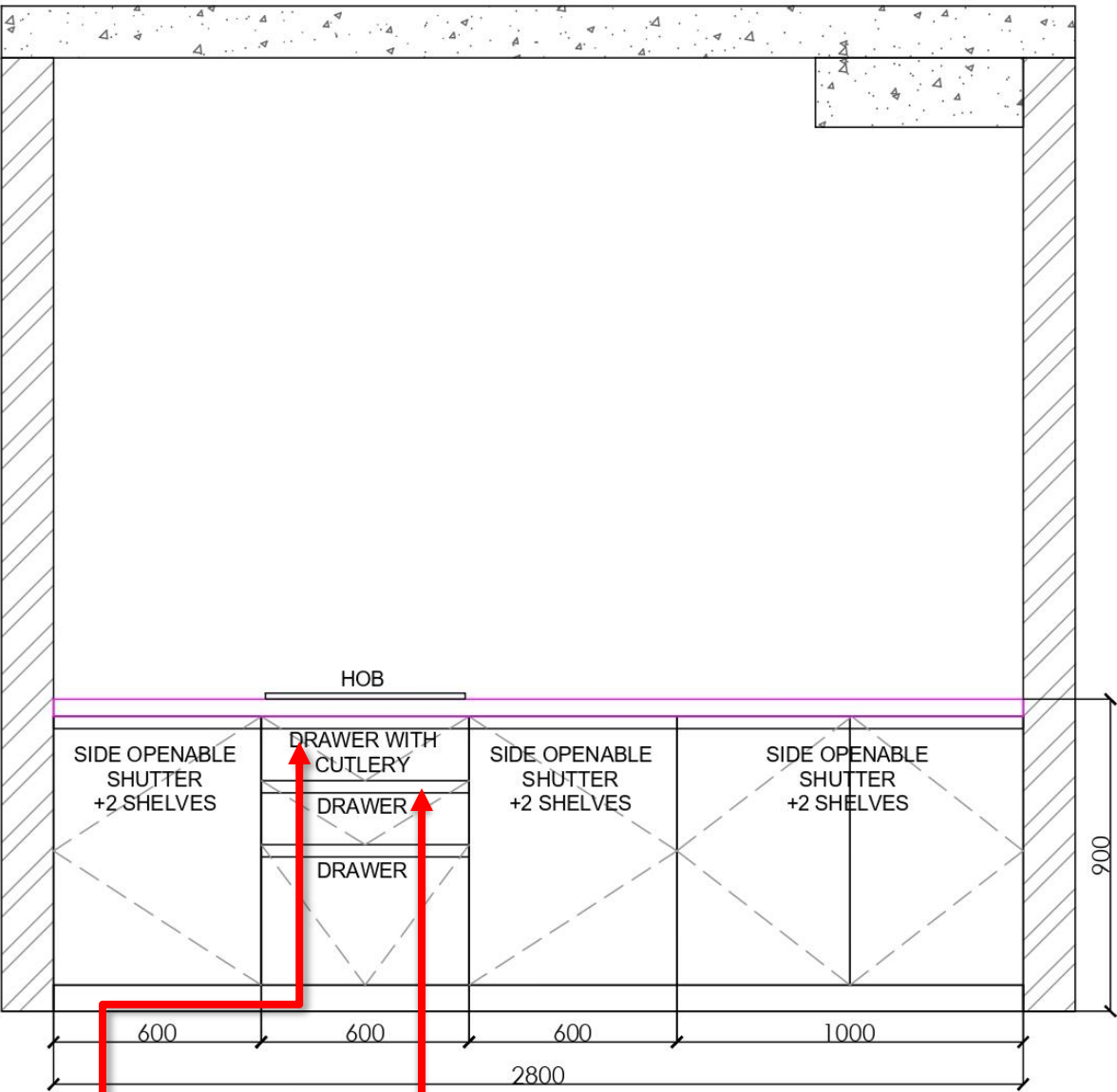

ELEVATION A



PVC CUTLERY TRAY



HETTICH-ATIRA DRAWER

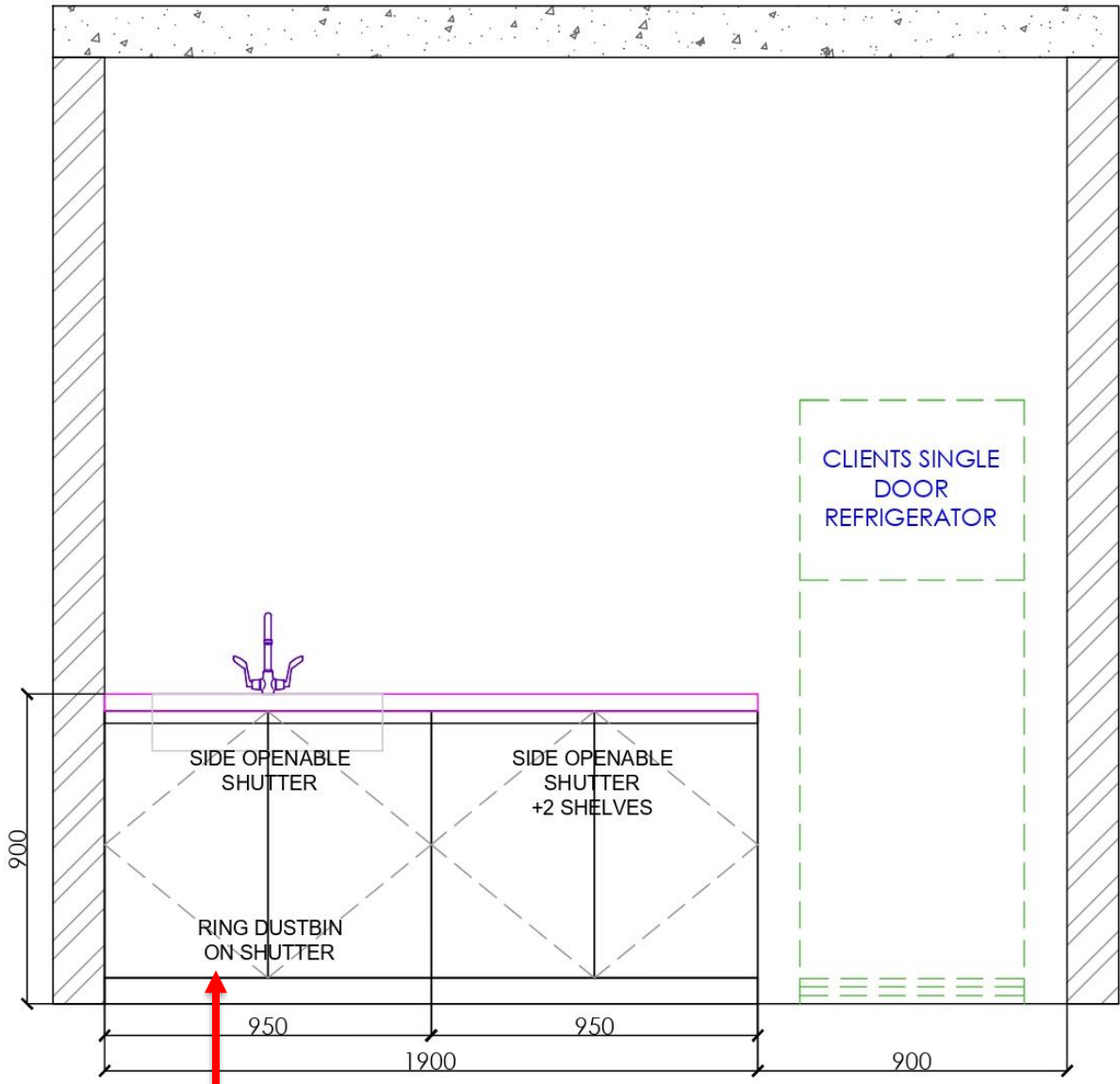

ELEVATION B



RING DUSTBIN BELOW  
THE SINK